

HUBEN K1 AIR RIFLE

HANDLING & INSTRUCTION MANUAL



THANK YOU FOR CHOOSING THE HUBEN K1!

**YOU ARE HANDLING A REVOLUTIONARY DESIGNED "HAMMERLESS"
SEMI-AUTOMATIC, PRE-CHARGED PNEUMATIC AIR RIFLE!**

PLEASE READ THIS MANUAL COMPLETELY BEFORE HANDLING OR SHOOTING.
USE CAREFULLY IN ITS OPERATION. OPERATE THE RIFLE CORRECTLY AND
SAFELY. OBTAIN AND OBEY THE RELEVANT REGULATIONS AND LAWS IN YOUR
LOCATION. AND BE RESPONSIBLE IN YOUR USE OF THIS AIR RIFLE.

WARNING: Do not attempt to disassemble this air rifle yourself. Please send the air rifle to a qualified repair technician. See the Huben web site for a list of Huben approved repair locations.

WARNING: Not a toy. This air rifle is intended for adult use only. Misuse or careless use may cause serious injury or death.

WARNING: Never point this air rifle at anything you don't wish to kill or destroy.

WARNING: Lead pellets. Do not inhale dust or put pellets in mouth. Wash hands after handling. This product contains lead, a chemical known to public to cause cancer and birth defects (or other reproductive harm).

WARNING: Use only clean and dry "compressed air" or "inert gas" (example: Nitrogen). Do Not Use Oxygen or other combustible gasses, which can cause a fire or explosion that could result in death or serious injury.

WARNING: This air rifle could fire when dropped or jarred, with or without the safety engaged.

WARNING: Working temperature: - 10°C / 14°F to 60°C / 140°F

Before using your new air rifle, check if it is properly charged (see "FILLING THE RIFLE") and obey these basic safety rules:

1. This air rifle can cause serious injuries and even death, whether it is loaded or not.
2. Never point the rifle at anyone, or allow anyone pointing a rifle at you, treat the rifle as if it is always loaded, Never assume it is unloaded.
3. Always carry the rifle with the safety on "SAFE" and in such a way that the direction of the muzzle will be under your control, even if you stumble.
4. Always be sure of your target and what lies behind it before firing the rifle.
5. Never leave a loaded air rifle unattended.
6. Beware of targets that tend to cause ricochets (water, rocks, metal... etc)
7. It is recommended that eye & ear protection are worn when charging the cylinder and while shooting.

Please read this owner's manual completely. Keep in mind that an air rifle is not a toy. Always carefully follow the safety instructions in this manual and keep this manual for future reference.

PART 1. BASIC COMPONENTS

Figure 1. BASIC COMPONENTS

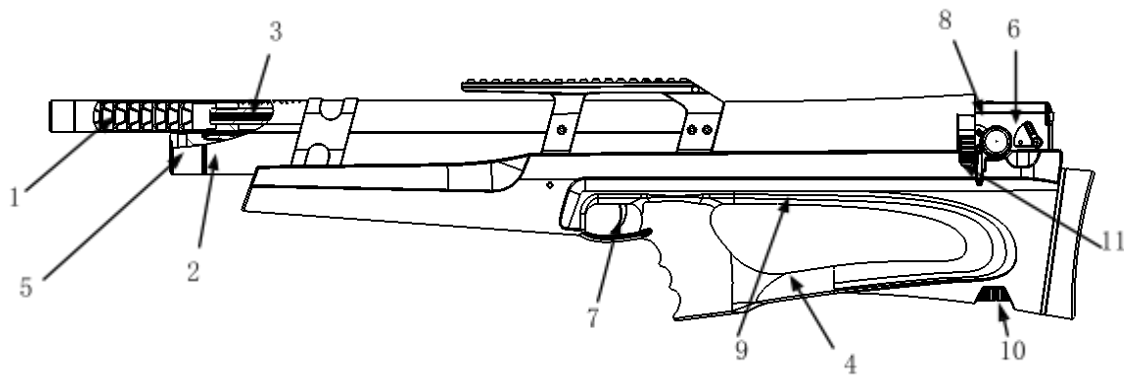

1. Suppressor 2. Cylinder Tube 3. Barrel 4. Stock 5. Fill Hole
6. Safety 7. Trigger 8. Pressure Gauge 9. Constant Pressure Regulator
10. Velocity Adjuster 11. Magazine / Release Lever

PART 2. SPECIFICATION

MODEL	K1
BARREL	560mm / 22 inches
CALIBER	.22(5.5mm) OR .25(6.35mm)
VELOCITY	UP TO 1000fps
SAFETY	MANUAL SAFETY
CYLINDER PRESSURE	MAX 35MPa / 350bars / 5075psi
AIR CAPACITY	292ml, TITANIUM ALLOY
CONSTANT PRESSURE	ADJUSTABLE CONSTANT PRESSURE (15MPa to 20MPa)* * 1 MPa (Megapascal)= 10 Bar = 145 psi
MAGAZINE TYPE	AIR INDEXING ROTATION .22(5.5mm) – 19shots; .25(6.35mm) – 17shots
SUPPRESSOR	INTEGRATED BAFFLES INSIDE SHROUD WITH VENT HOLES
POWER SETTING	CHANGEABLE POWER SETTING From 8J/6 FPE to 100J/74 FPE
SCOPE RAIL	PICATINNY RAIL (built-in bubble level)
STOCK	SYNTHETIC STOCK OR WOODEN STOCK
DIMENSION (L×W×H)	810mmX50mmX190mm / (32inx2inx7.5in)
NET WEIGHT	3.4kg / 7.5 pounds
ACCESSORIES	FILL PROBE, SPARE PARTS PACKAGE, TOOLS, OWNER'S MANUAL

PART 3. FUNCTION

1. Easy operation and high power (precision semi-auto valve without hammer.
2. High performance integrated silencer with tiny vent holes for a light and gentle report .
3. Integrated charging port with replaceable filter (standard version). Various filter materials can be utilized such as: paper, cotton, even napkin, as well as desiccant dryer material for cleaning the air supply) Optional version: air tank pressure gauge without replaceable filter option. (in this case it is highly recommended your fill source has a similar filter attached as outlined above).
4. Easy to load 19 shot (.22 Caliber) or 17 shot (.25 caliber), non-removable circular magazine.
5. Adjustable regulator (constant pressure) (the pressure can be adjusted to fit for various pellets/slugs to obtain the best shooting accuracy) .
6. Adjustable dynamic power to meet shooting requirements
7. Titanium alloy air reservoir (withstands higher pressure for increased shot count) .

PART 4. OPERATION

1. MANUAL SAFETY

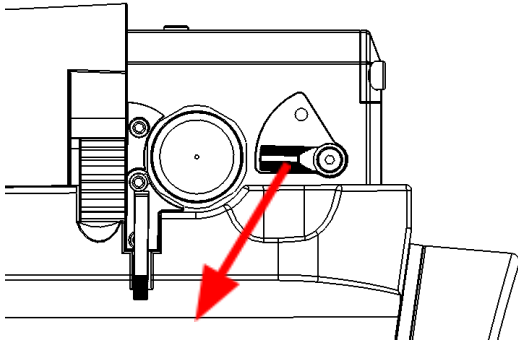

Figure.2

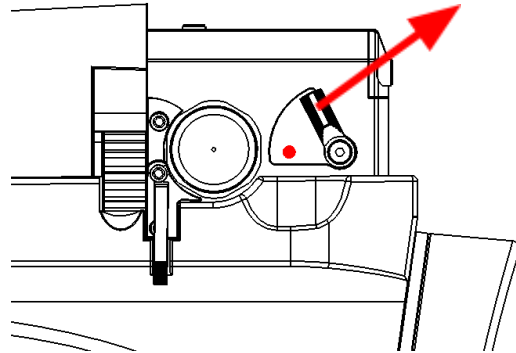

Figure.3

- ❖ Safety can be set to ON/OFF by hand.
(If you see the red dot, the gun can shoot, the safety is in the “off” (upward) position. If the red dot is covered, the gun is said to be “theoretically safe”, the gun shouldn’t shoot with the safety in this “safe” or “on” (downward) position. Never trust the safety 100%, always assume the gun could shoot even with the safety in the “safe” or “on” position.)
- ❖ (Figure 2) Push the SAFETY lever in the direction of the arrow to the “SAFE” position, the trigger is blocked and the gun cannot be shot.. (the red dot isn’t visible).
- ❖ (Figure 3) Push the SAFETY lever in the direction of the arrow, to the “off position” . The gun can be fired. (The red dot is visible)
- ❖ To avoid accidental discharge, keep the safety on “SAFE” until you are sighted in on your target and ready to take the shot.

2、 FILLING THE RIFLE

- ❖ When filling the rifle ensure the magazine is unloaded.
- ❖ Be sure that the safety is on “SAFE” when filling the rifle, to avoid accidental firing.
- ❖ If your K1 is equipped with the air cylinder gauge, use care when sliding open dust cover as extensive force can cause accidental removal and release/loss of retaining springs and balls.

Attach the fill probe to your charging equipment, which should be equipped with a pressure gauge. Ensure both the fill probe and the filler hole are clean from dirt, and then insert the fill probe into the filler hole (See Figure.4).

We recommend you fill the cylinder to at least 20MPa / 2900 psi.

Never exceed the maximum storage pressure of 35MPa / 5000 psi.

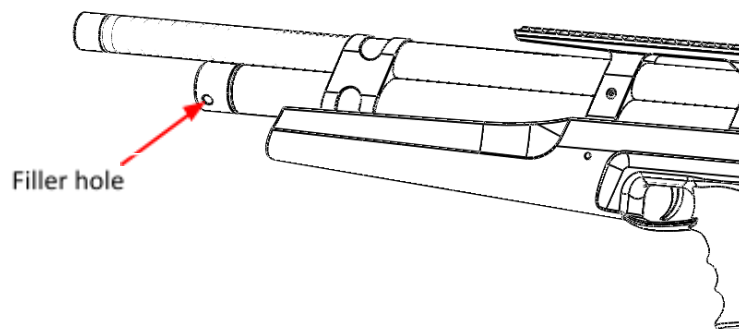

Figure.4

- ❖ After filling the rifle, open the bleed valve on the filling equipment, ensure the air in the hose is exhausted out, then remove the fill probe from the filler hole.
- ❖ The air reservoir is not removable. DO NOT attempt to disassemble the rifle under any circumstance.
- ❖ When the temperature of the environment is below 0°C / 32°F , moisture in the K1 cylinder can do extensive damage to o-rings and seals. USE CLEAN DRY AIR AT ALL TIMES!
- ❖ Check and renew the filter element frequently. (if you have the air cylinder endcap with filter and without pressure gauge).
- ❖ It is best to store the rifle with air in the cylinder. If storing for extended period, store at 15 MPa / 2175 psi

3、 REGULATOR AND POWER ADJUSTER

- ❖ Typical regulator setting for most shooting conditions and set from the factory is 15 MPa. (see Figure 5) The regulator setting is dependent on several variables including: weight of projectile, desired velocity, shot count, cylinder fill pressure, accuracy. The adjustable power, (see Figure 6) should be set by tracking the number of “clicks” as compared to the regulator pressure setting. Excessive clicks to “open” or “screwed out” position could lead to unusual leakage and valve resetting failure (dumping air out the barrel and emptying cylinder).
- ❖ In case the pellets can’t be fired, the adjustable power should not be set too low for heavy and over-sized pellets. Recommended starting point is 10 clicks “open” from the full closed position. (see Figure 6)
- ❖ The regulator pressure will increase or decrease after a long period of non-use, while it will return back to normal when you use it. Note to adjust the adjustable power from the low to the high. (see Figure 5)
- ❖ When you clean the barrel, be certain that the magazine is unloaded and adjust the adjustable power wheel to the fully closed and lowest setting. (see Figure 6)

REGULATOR PRESSURE ADJUSTMENT

Projectile	Regulator start point	Power wheel start point
Light	15-16 MPa	10 clicks from closed
Average	16-18 MPa	25 clicks from closed
Heavy	18-20 MPa	30 clicks from closed

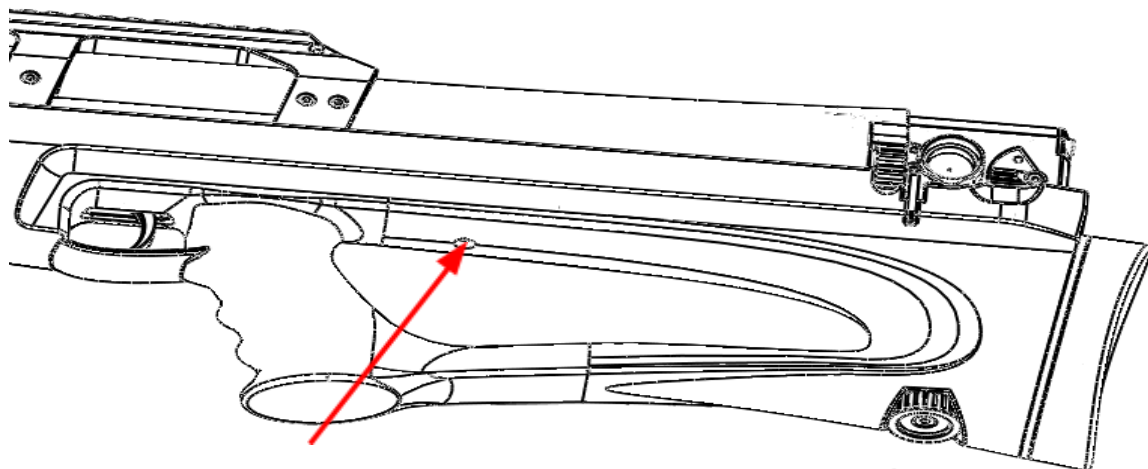

The pressure increases when turn clockwise and lowers when counter-clockwise)

Tool: Allen wrench

Figure.5

POWER WHEEL ADJUSTMENT:

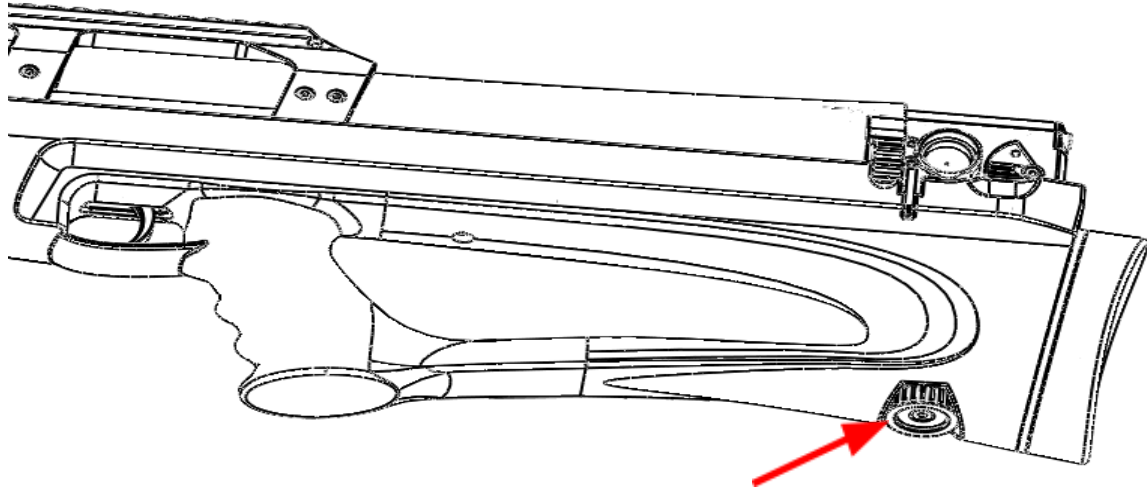

Velocity adjustment (the adjustable power lowers when turned clockwise and increases when turned counter-clockwise)

Figure.6

ADJUSTMENT TO FIRST STAGE FEEL OF TRIGGER

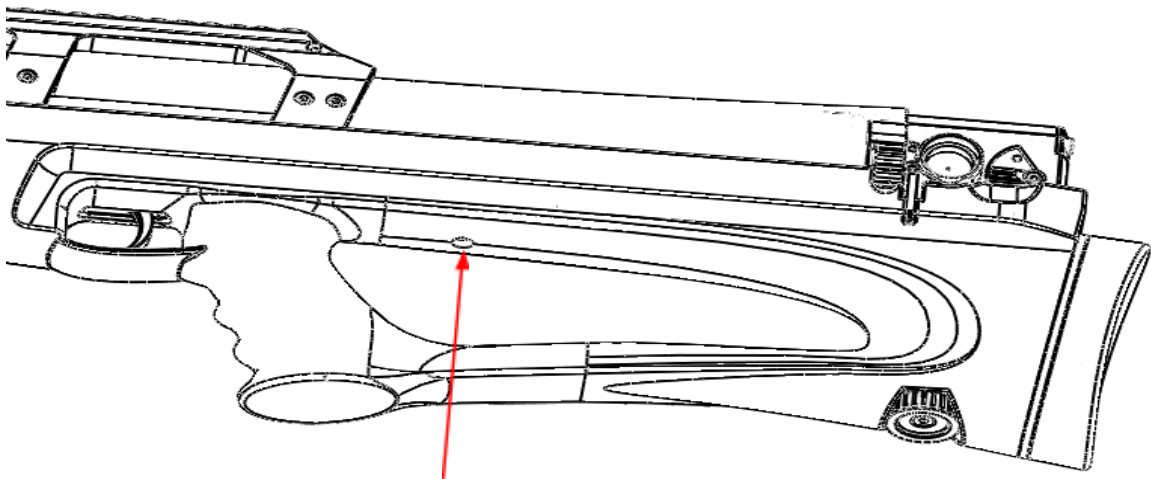

Adjust the cocking spot of trigger (forward or backward the cocking spot of trigger with allen wrench)

Figure.7

LOADING PELLETS

1. Lift the magazine release lever and the magazine can be revolved freely. Carefully lower release lever after loading magazine. Do not allow the lever to slam down.

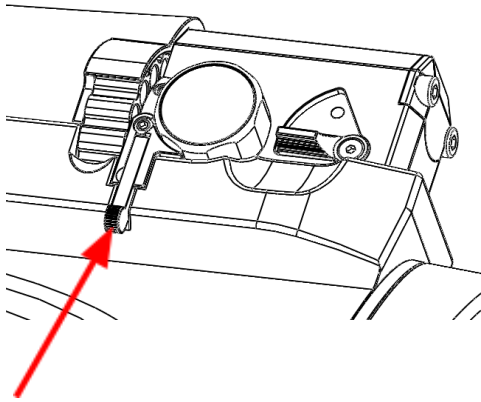

Figure.8

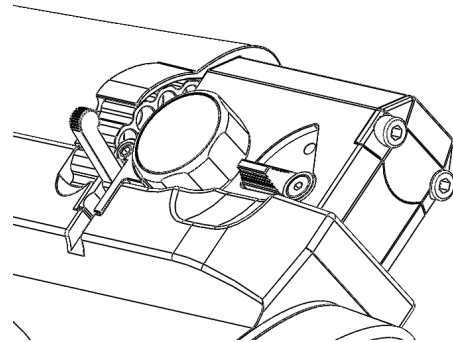

Figure.9

2. Load pellets

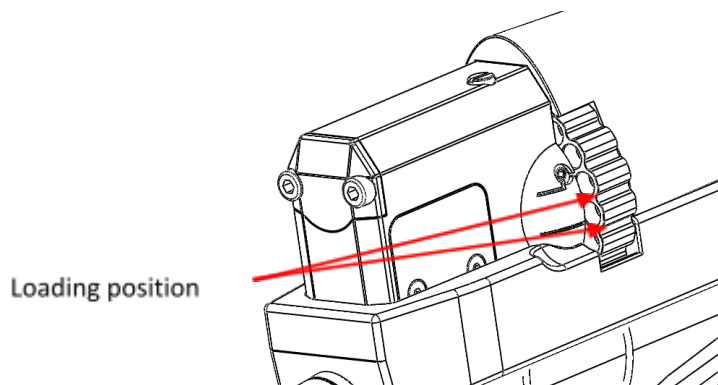

Figure.10

- ❖ With your gun pointed down to the ground or downrange in a horizontal orientation, load your pellets and ensure they are set under the surface of the magazine. Rotate the magazine one full rotation after loading pellets to verify a smooth and unobstructed rotation. This process ensures the magazine will rotate when firing.
- ❖ During loading the magazine, undersized pellets might cause the pellet “falls” partly into the barrel, especially when the gun is pointed down. If this happens (usually after loading 16 pellets), stop loading and start shooting.
- ❖ Use soft metal pellets only ; Lead (pb) or Tin (sn).

4. FIRING / SHOOTING

- ❖ Always point your air rifle at a SAFE DIRECTION.
- ❖ You and others with you should always wear shooting glasses to protect your eyes.
- ❖ Do not shoot at hard surfaces or at the surface of water. The pellet may bounce off or ricochet and hit someone or something you had not intended to hit.
- ❖ Always choose your target and backstop carefully.
- ❖ Your air rifle is suitable for both indoor and outdoor use. Please aim your target carefully. THINK about what you will hit if you miss the target.

TROUBLESHOOTING

1、 PELLET STUCK:

RESULTS: unusual leakage (dumping all air out the barrel), cocking reset failure, magazine wont rotate, and the safety can't be moved to the "SAFE" position. This happens because of oversized or deformed pellets (pellet wasn't fully seated inside the magazine or the pellet diameter is too small to stay set in the center of the magazine.

SOLUTION :

- ❖ Adjust the power wheel to the closed or lowest power setting.
- ❖ With a cleaning rod, measure from tip of the shroud to the obstruction. Remove and place the cleaning rod on the side of the K1 to see how deep the obstruction is. If the obstruction is less than one pellet length or less you should be able to push the pellet back into the magazine. If the measurement is one pellet or more, send it to your selected service center.
- ❖ Cleaning rod or unjamming rod should not be inserted completely through the magazine or damage to breach seal and open valve face can occur.
- ❖ If one pellet is found to be the jam, gently "tap" the pellet back into the magazine allowing the magazine to resume proper rotation. While tapping you may need to turn the magazine right and left in a rocking motion to allow the pellet to move back into the magazine.

2、 UNMATCH BETWEEN DYNAMIC POWER AND REGULATOR PRESSURE :

RESULTS: Unusual leakage (dumping all air out the barrel), sometimes cocking failure and the safety lever can't be moved to the "SAFE" position.

SOLUTION :

When the regulator pressure is over 15mpa,,

- ❖ Lower the dynamic power to zero (power wheel closed) and Regulator pressure below 10mpa.
- ❖ Increase the regulator pressure up to 15-18MPa, The internal mechanism will “cock” at approximately 10MPa, the magazine will actuate at approximately 15MPa.

3、 UNUSUAL FIRING :

RESULTS: The pellet fails to come out from the magazine chamber after firing.

- ❖ Ensure that cylinder pressure is at least 5MPa higher than your set regulated pressure
- ❖ Check the air gauge to be sure regulated pressure is at typical operating (15-16MPa) or your adjusted setting. You should stop shooting and refill the air cylinder when you notice your regulated pressure drops.

SOLUTION :

- ❖ Refill the air cylinder

4、 ACCURACY LOWERED

In general, it is caused by using a low quality pellet, lead fouling of the barrel, or debris in the shroud and baffling. This can be solved by using a higher quality pellet or cleaning the barrel, shroud, and baffles.

5、 OTHERS:

Please consult your local dealer or The Huben factory representative.

SAFETY MEASURES & WARNINGS

- ❖ This air gun will shoot if cocked, loaded, safety disengaged and trigger pulled.
- ❖ Air guns are not toys. Never let young children use an air gun unsupervised. Adult supervision is strictly required during use. Misuse or careless use may cause serious injury or death.
- ❖ Learn how your air gun operates and safe air gun handling procedures before loading and using it.
- ❖ ALWAYS USE EYE & HEARING PROTECTION AND MAKE BYSTANDERS USE THE SAME. Failure to do so may result in eye injuries and permanent hearing loss.
- ❖ Do not point at anything you do not intend to shoot even though the air gun is unloaded. Always keep the air gun pointed in a safe direction.
- ❖ Never pull an air gun toward you by the muzzle.
- ❖ Always aim at a safe target, taking care that it does not conceal any other object.
- ❖ Before you shoot, consider where the pellet will travel should you miss your intended target, thus ensuring no damage or harm could result. Be sure of your target before you pull the trigger. Never shoot at sounds.
- ❖ When shooting, always have a safe shooting range, that is; have a safe area for shooting, a safe distance between you and the target, and a safe backstop to trap the pellets and hold the target.
- ❖ Do not shoot at a target, which allows ricochets or deflections. Do not shoot into or at water.
- ❖ Do not shoot at or near power lines or insulators. Be especially careful in wooded areas where power lines may not be as visible.
- ❖ Do not load the air gun until you are ready to shoot.
- ❖ Always keep your fingers away from the trigger & muzzle during cocking and

handling.

- ❖ Do not run or jump when carrying a loaded or cocked air gun. A loaded or a cocked air gun should never be carried inside a vehicle, house, camp or public place. Never climb a tree or fence or jump a ditch with a loaded air gun. In such a case, first unload it and hand the air gun to a friend or place it on the ground on the other side of the obstacle before crossing yourself.
- ❖ When transporting the air gun, keep it unloaded and “ON SAFE”.
- ❖ Always keep the air gun ‘on safe’ until you are ready to shoot even if the air gun is unloaded.
- ❖ Do not put the air gun away loaded and unattended.
- ❖ Always check to see if the air gun is “on safe” and unloaded when getting it from another person or from storage.
- ❖ Always keep the air gun and/or pellets out of the reach of children. Keep the air gun and pellets in separate places, better if under lock and key.
- ❖ Do not attempt to disassemble or tamper with your air gun. Use a competent gunsmith. Many air guns contain powerful springs or high pressure air cylinders which can cause serious injury if released in an uncontrolled manner.
- ❖ Always handle and treat your air gun as though it were loaded.
- ❖ Improper use or handling of air guns is not the responsibility of the manufacturer or distributor, under any circumstances. The user is responsible for any harm, which may be caused.
- ❖ Think first, shoot second. Don’t rely on any mechanical safety. Half safe is not safe.
- ❖ Be safe, not sorry. Respect others' property.
- ❖ Air guns should never be used under the influences of alcohol or drugs.

Factory Recommended Settings

.22 caliber:

Pellet Weight	Working Pressure	Velocity
1.175g (18.13gr)	12-13MPa (1740-1885 psi)	280-290m/s (918 - 952fps)
2.2g (33.95gr)	15-17MPa (2175-2465 psi)	280-290m/s (918 - 952fps)

.25 caliber:

Pellet Weight	Working Pressure	Velocity
1.645g (25.38gr)	13-15MPa(1885-2175 psi)	280-290m/s (918 - 952fps)
2.2g (33.95gr)	15MPa (2175 psi)	280-290m/s (918 - 952fps)

Data verified 8/24/2021

Results based on testing with JSB Pellet products.

Notes for your own settings

Tips: Make note of the original setting before you start tuning your air rifle.

Caliber				
Regulator Pressure				
Power Setting/Energy				
Power tuning Adjuster				
Velocity				
Pellet/Slug				
Pellet/slug Weight				
Distance				
Remarks				

Contact information:

Huben Hong Kong Co., Limited

Email: huben@hubenairguns.com

Website: www.hubenairguns.com

Skype: [hubenairgun](https://www.skype.com/people/hubenairgun)

Facebook: [Huben Jacky](https://www.facebook.com/HubenJacky)

WeChat: [Huben - Jacky](https://www.wechat.com/p/Huben-Jacky)

